

GETTING TO SCHAFFER'S CAMP

The Schaffer's experience is as much about the journey as it is the destination! Getting to Schaffer's requires two gondola rides and a bit of walking. Give yourself extra time so you arrive in time for your reservation.

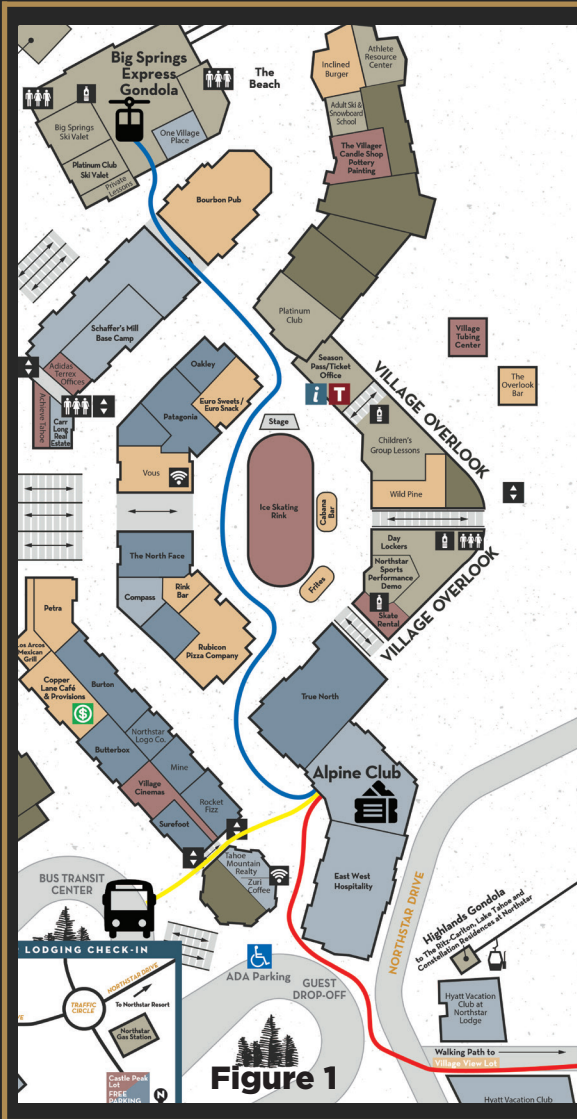

THROUGH VILLAGE

Arriving by bus: Follow yellow line.

Arriving by car: Follow the red line,

Alpine Club: Stop here to request walking passes (lift tickets) from Ski Valet. These are required to access the gondolas.

Big Springs Gondola: Follow the blue line to the Gondola. Enjoy the ride!

ACROSS SNOW

Mid-Mountain: Exit gondola. Follow the blue line (figure 2) to Zephyr Express.

Board Zephyr: Walk in between the lift line and the Ski Patrol building and wait for a gondola. Pedestrians have priority over people with ski gear.

Walk to Schaffer's: At the top of Zephyr Express (figure 3), Schaffer's is immediately in front of you, about 100 feet away. Happy dining!



TAHOE MOUNTAIN CLUB

